

traronTM SERIES

FS700-5

TRANSFORMER OUTPUT MANIPULATIVE [TOM]
BATTERY TAB WELD STATION.

The **FS700-5** welding platform was designed according one of company's patent, technologies of "**TRANSFORMER OUT PUT MANIPULATION [TOM]**". It is a brand new welding control theory which invented by our R&D team at 2005. A latest large energy control method applying in resistance welding.

FS700-5 welding station equipped with a **FC700-5** advance power unit with weld power monitor and a precision **PNE BS-5** differential pressure weld head. With this prefect combination, resulting in less part deformation clean and reliable welds with high accuracy repetition.

The station is ideal for jointing thin tab materials and batteries to a wide variety, the superior was special developed to work in high quality/volume production environments, where joint security, reliability, quality, cost per part and maintenance are important.



PORON[®]

FS700-5
TRANSFORMER OUTPUT MANIPULATIVE [TOM] POWER UNIT

PORON[®]

OVERALL SIZE..

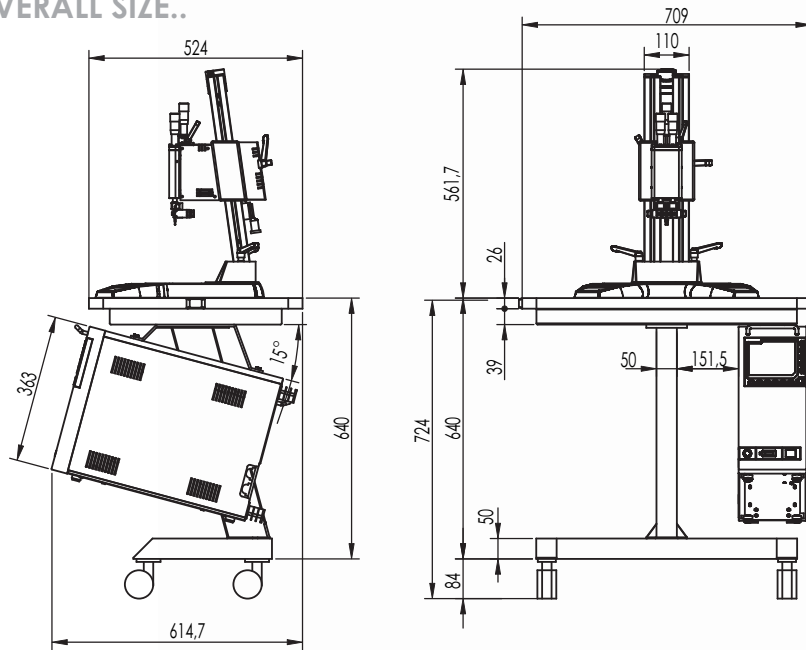

CONTENTS..

PNE BS-5 WELD HEAD.

Dual springs forced weld head with differential pressure actuating.

FC700-5 WELD POWER UNIT.

Precision "Transformer Output Manipulative [TOM]" 7000 amperes power unit.

WS WORK TABLE.

On wheels movable work table provides production flexibility.

FEATURES..

1. Patented "TOM" advance technology.
2. Ergonomically design both for performance and appearance.
3. Full colour graphical display.
4. Simple on screen setting up.
5. Weld energy monitor built-in.
6. Weld patterns library for uploading.
7. Weld perimeters store and recall.
8. Bi-directional welding pulses.
9. Pre-check function.
10. Weld terminator.
11. Fine forces weld head with rapid following up.
12. Differential pressure actuating system.
13. Large working platform.
14. Tuning screw throat alignment with clearance fine tune.
15. Production flexibility.
16. Single phase power source.

NOTE.. Further features and specifications for the FC700-5 POWER UNIT and PNE BS-5 TAB WELD HEAD please refer to related catalogues.

ACCESSORIES..

Included accessories..

Power cables, signal cable, foot switch, tool box and tools, electrodes and holders, air input coupler, instruction manual, warranty sheet.

Optional accessories..



ISO9001: 2000
Cert No.: 121 0025 097

PORON INTERNATIONAL LTD.
WWW.poronHK.com
Email: info@poronhk.com